

ALTADENA LINCOLN CROSSING SOUTH

FOR LEASE



KEY FEATURES

A mixed-use project built in 2007 on 2.22 acres, anchored by 24-Hour Fitness, and parking structure with 217 spaces

NEC of Lincoln Ave. & Woodbury Rd. in unincorporated Altadena of LA County

Units for Lease:

Address	GLA (SF)	Use
2204 #A Lincoln	2,650	Retail/Office
2208 Lincoln	1,150	Retail/Office
2216 Lincoln	950	Retail/Office
2220 #C Lincoln	830	Residential

*2180 - 2220 Lincoln Avenue
Altadena, CA 91001*



APN: 5827-018-041 – Zoning: C3



The information contained herein is derived from sources deemed reliable, but provided without representation or warranty. Neither KP nor the owner guarantees its accuracy.

Darian Wang

(909)282-8217

dwang@kanderpacific.com

DRE Lic # 01922077

Jenny Chang

(909)781-9992

jennychang@kanderpacific.com

DRE Lic # 02078214

ALTADENA LINCOLN CROSSING SOUTH

2180-2220 LINCOLN AVE., ALTADENA, CA

SITE PLAN

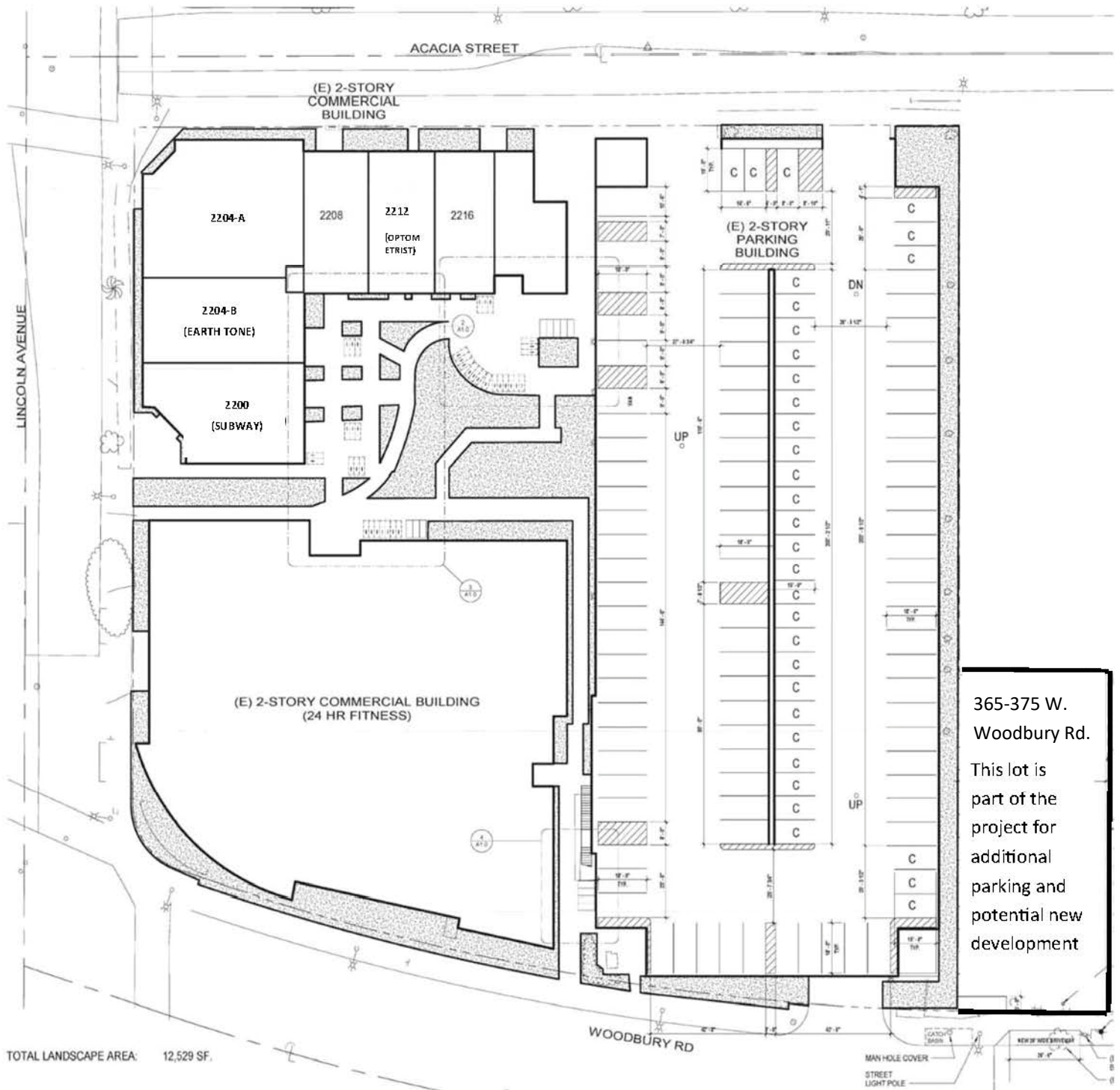

The information contained herein is derived from sources deemed reliable, but provided without representation or warranty. Neither KP nor the owner guarantees its accuracy.

Darian Wang

(909)282-8217

dwang@kanderpacific.com

DRE Lic # 01922077

Jenny Chang

(909)781-9992

jennychang@kanderpacific.com

DRE Lic # 02078214